

roof tiles - Redland Cathedral clay pantile 80 Terra cotta - smooth finish  
 \* Walls - vertical boarding With gap joint - painted to match large barn.

GROUND FLOOR Small Barn 1:100

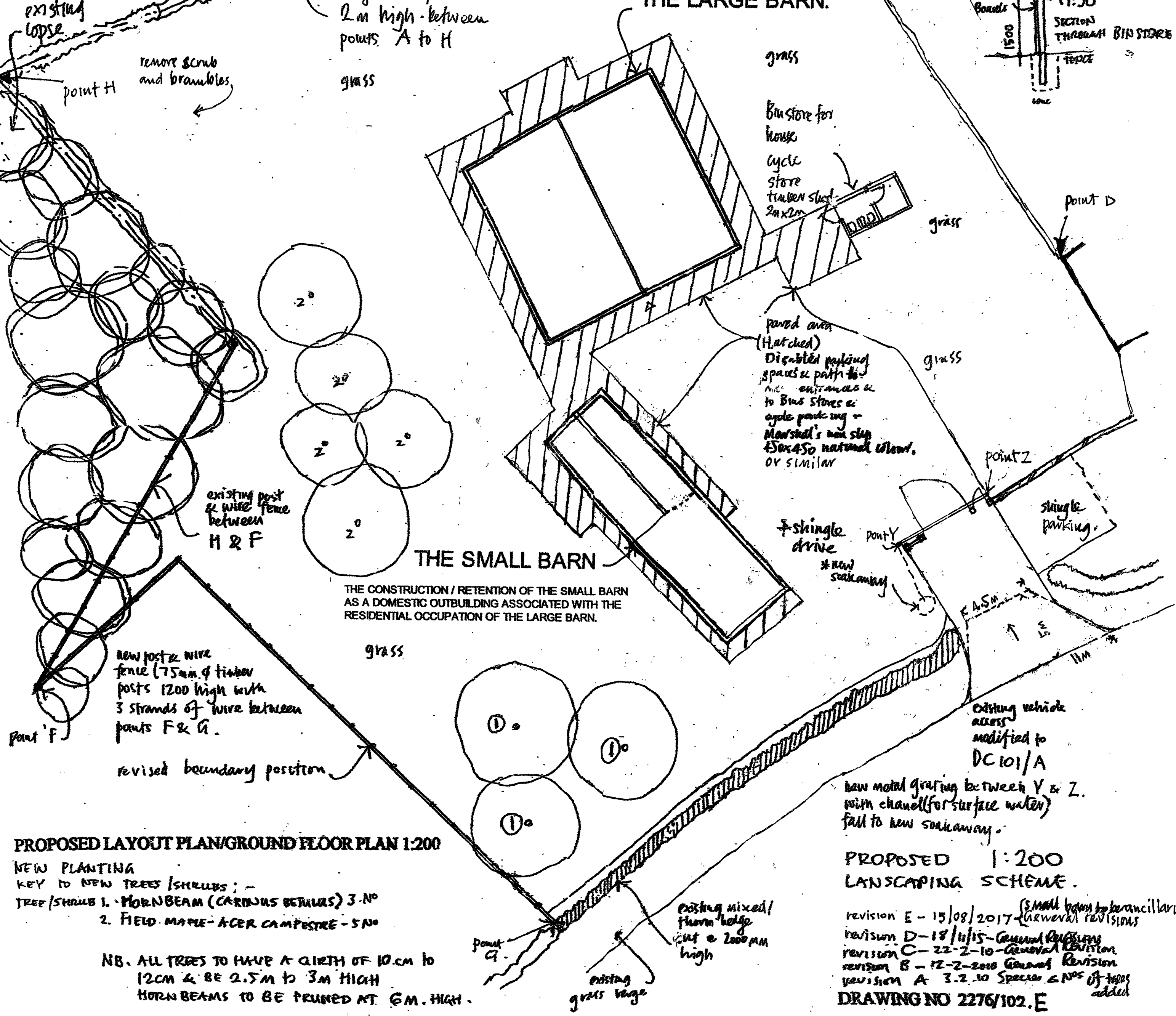

PROPOSED LAYOUT PLAN/GROUND FLOOR PLAN 1:200

NEW PLANTING  
 KEY TO NEW TREES / SHRUBS :-  
 TREE / SHRUB 1. HORNBEAM (CORNUS BETULUS) 3 NO  
 2. FIELD MAPLE - ACER CAMPESTRE - 5 NO

NB. ALL TREES TO HAVE A GIRTH OF 10 CM TO 12 CM & BE 2.5 M TO 3 M HIGH  
 HORNBEAMS TO BE PRUNED AT 6 M. HIGH.

PROPOSED 1:200 LANDSCAPING SCHEME.

revision E - 15/08/2017 (Small barn to be ancillary to the main house)  
 revision D - 18/11/15 - General Revisions  
 revision C - 22-2-10 - General Revisions  
 revision B - 12-2-2010 General Revision  
 revision A - 3.2.10 Species & NPS of trees added

DRAWING NO 2276/102.E